

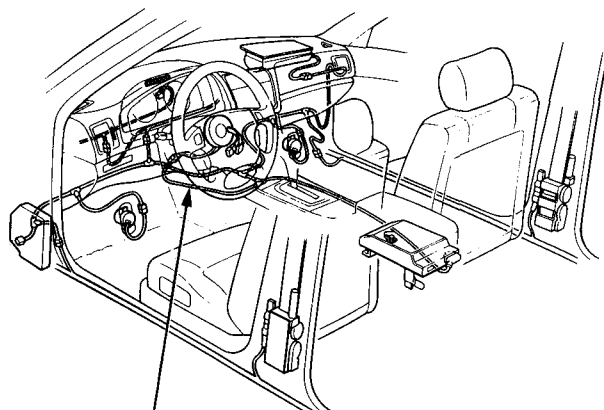

Steering Lock Replacement

CAUTION:

- All SRS wiring harnesses are covered with yellow outer insulation.
- Before disconnecting any part of the SRS wire harness, install the short connectors (see page 23-407).
- Replace the entire affected SRS harness assembly if it has an open circuit or damaged wiring.



SRS MAIN HARNESS
(Covered with yellow outer insulation)

1. Pry the courtesy light controller and TCS switch (GS) out from the dashboard lower cover.

NOTE: Be careful not to damage the controller and TCS switch (GS) or the dashboard lower cover.

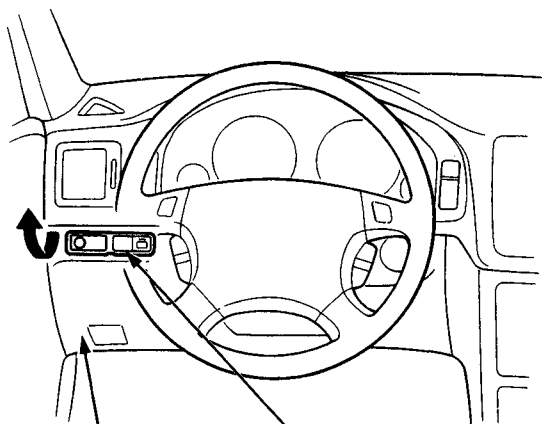

DASHBOARD LOWER COVER

COURTESY LIGHT CONTROLLER and TCS SWITCH (GS)

2. Disconnect the connectors from the courtesy light controller and TCS switch (GS).

3. Remove the dashboard lower cover.

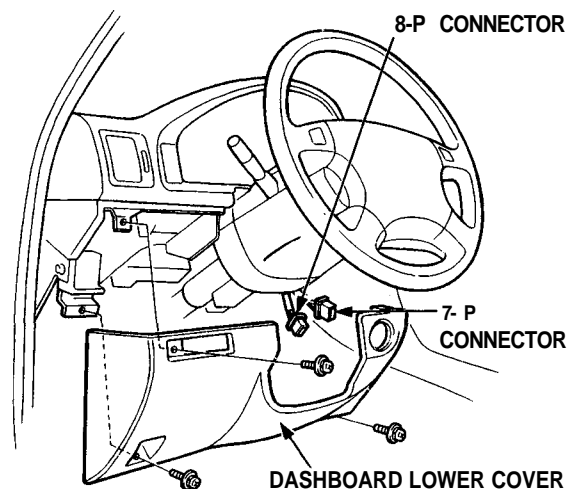

4. Disconnect the 8-P and 7-P ignition switch connectors.

5. Remove the steering column tilt and upper and lower covers (see page 23-186, 187), then remove the column holder mounting bolts and the mounting nuts.

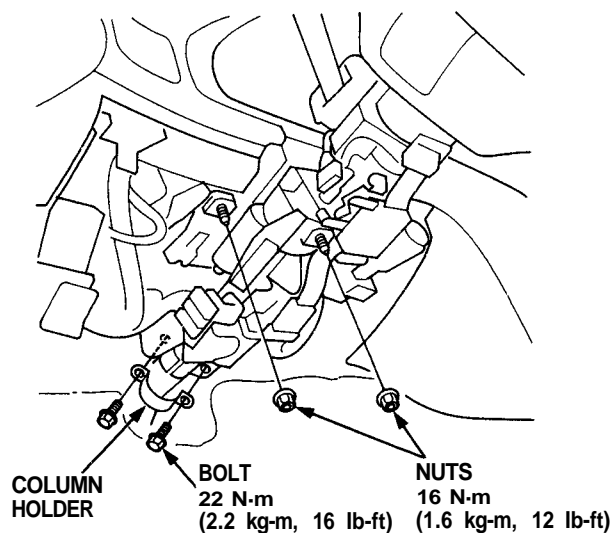

6. Lower the steering column assembly.

(cont'd)

Ignition Switch

Steering Lock Replacement (cont'd)

7. File a notch into the shear bolt head.
Set the tip of a chisel or a screwdriver in the notch, and loosen the bolt by tapping its head counterclockwise.

CAUTION: Do not damage the switch body.

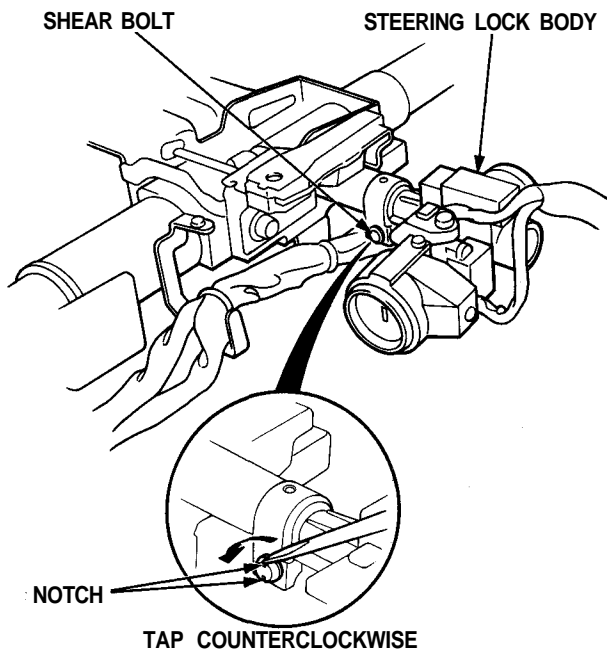

8. Remove the shear bolt from the switch body.

9. Insert the key and turn it to "I".
10. Push the lock pin down.

NOTE: The illustration shows A/T.

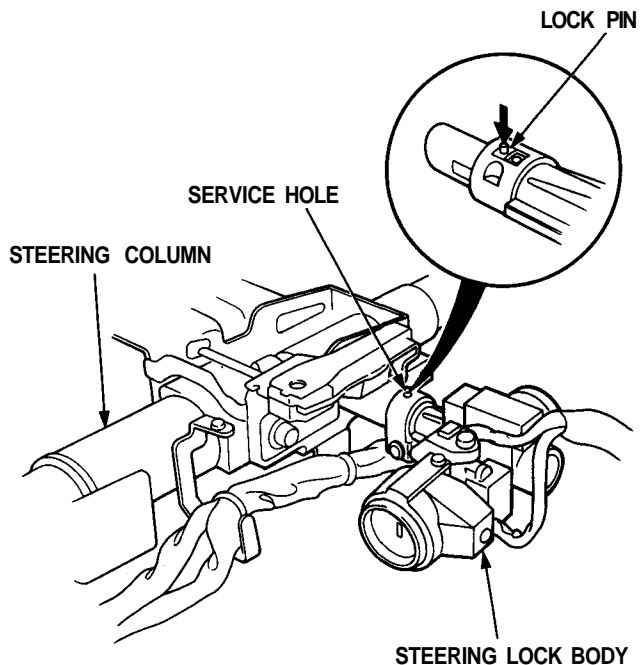

11. Pull out the steering lock body.

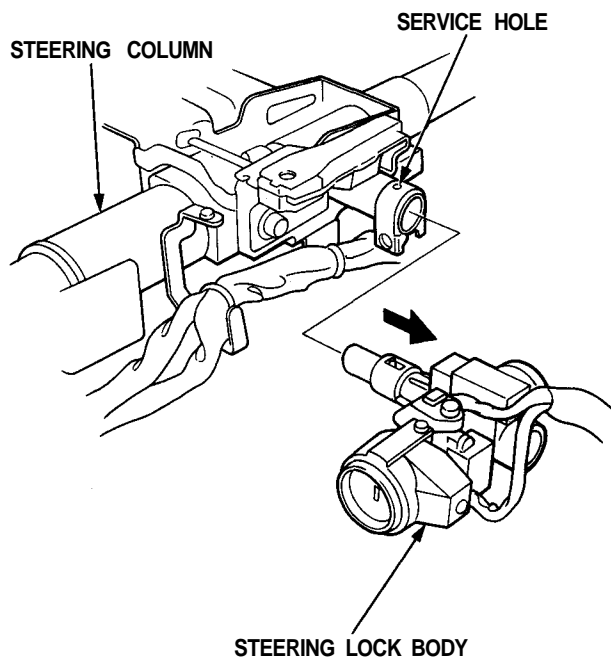



12. Turn the key to "I", push the pin down and insert the new steering lock body into the steering column until it clicks into place.
13. Loosely install the new shear bolt through the knee bolster bracket.

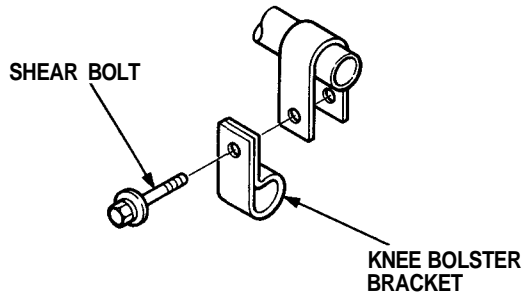

14. Insert the ignition key, and check for proper operation of the steering wheel lock, and that the ignition key turns freely.

15. Fit the steering lock body in the dashboard lower cover.

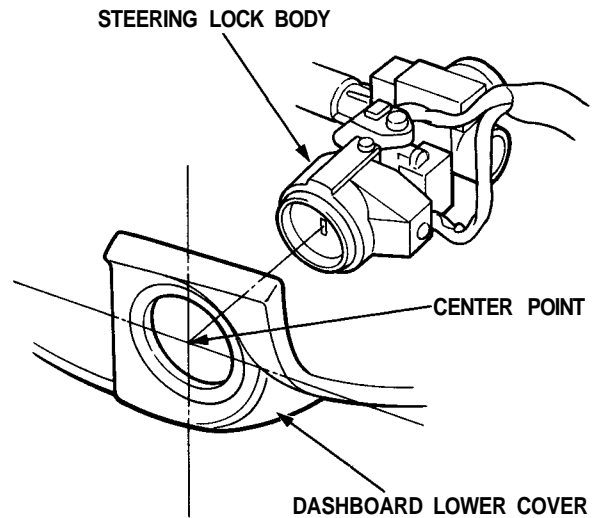

16. Tighten the shear bolt until the hex head twists off.

